

Nad's Precision EYEBROW WAX WAND

DIRECTIONS FOR USE: READ ALL DIRECTIONS, WARNINGS AND PRECAUTIONS CAREFULLY BEFORE USE. FAILURE TO FOLLOW THESE INSTRUCTIONS MAY RESULT IN SKIN IRRITATION OR OTHER INJURY.

1. CLEAN AREA

Thoroughly clean the area to be treated using a Nad's Cleansing Wipe or non-moisturising soap. Ensure all oils, makeup and moisturisers are removed and then wipe skin completely dry. For extra foaming, moisten Nad's Cleansing Wipe with water (**Figure1**).

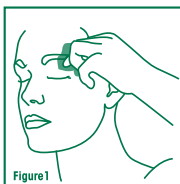

Figure1

2. APPLY NAD'S PRECISION WAND

WARNING: DO NOT MICROWAVE. Remove the wand cap and slowly twist the end until gel appears at wand tip. N.B. it is important to twist slowly to minimise pressure build up. When first used, this may take up to 20 twists. (**Figure2**) Slowly apply a thin layer of gel in the direction of hair growth (**Figure3**). Hair should be at least 3 to 5mm or 1/8 to 1/5 inches long. On areas such as the upper-lip hair can grow in different directions. Always assess carefully before applying the gel. Nad's Precision Eyebrow Wax Wand is best used at normal body and room temperature (room: 22°C/ 72°F). But when it is cold or if the gel is too thick, briskly rub wand between hands for 20 to 30 seconds. Alternatively, place wand in a cup of hot tap water for 2 minutes, tip facing upwards, water level no higher than the © symbol. Ensure water does not come into contact with the gel as this will cause the gel to become ineffective. Only apply the gel over the hair you wish to remove. Any excess will wash away with warm water.

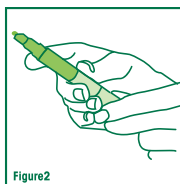

Figure2

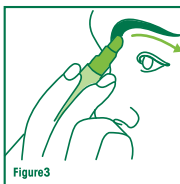

Figure3

3. APPLY COTTON STRIP

Immediately place strip over the gel. Using your index finger, firmly smooth over the strip 3 to 4 times in the direction of hair growth. (**Figure4**) Nad's Cotton Strips can be washed and reused.

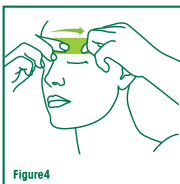

Figure4

4. REMOVE GEL

Holding skin taut with one hand, quickly pull strip off in the opposite direction of hair growth (**Figures5,8&9**). The quicker you pull the strip the more effective the hair removal. Remember to hold skin taut with the other hand and to pull close and parallel to the skin rather than away from the skin (**Figure6**). If any gel residue is left on skin, simply rinse away with warm water.

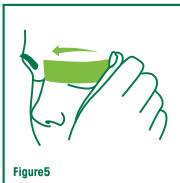

Figure5

TREATMENT AREAS:

• Upper Lip, Chin, Centre Brow and Eyebrows

Hair on upper lip grows in two directions, so treat it in two stages. Chin hair grows downwards toward the neck (apply gel in this direction) (**Figure7**); remember to pull the strip off in the opposite direction of hair growth, towards the nose (**Figure9**). Hair on the centre brow grows upwards towards the forehead (apply gel in this direction) (**Figure7**); the strip should be removed by pulling down towards the nose (**Figure9**).



(**Figure7**)
(Apply in this direction)

(**Figure8**)
(Hold skin taut & pull quickly)

(**Figure9**)
(Remove in this direction)

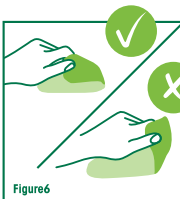

Figure6

(Remove strip close to skin. Don't pull upwards)

PRECAUTIONS:

- DO NOT MICROWAVE THE PRECISION EYEBROW WAX WAND.
- KEEP OUT OF REACH OF CHILDREN.
- Before each use, follow the directions to test the gel on a small area of skin you wish to treat. If after 24 hours there is no adverse reaction, proceed with full application.
- Not suitable for use on the scalp, nipple, perineal or genital areas.
- May not be suitable for the elderly or diabetics.
- Do NOT use if you are on any medication which can affect the skin or if undergoing any of the following dermatological treatments: topical retin A, skin peel, dermabrasion or laser resurfacing.
- Do NOT use on sunburnt, dry, flaky, broken or irritated skin; or over warts, pimples, moles, varicose veins or wounds; or if you have previously experienced adverse reactions to waxes.
- Do NOT use directly after a shower. Wait at least 15 minutes, until skin is dry and moisture-free.
- Allow 24 hours before using antiperspirant, perfume or astringent lotion on the treated area.
- It is normal for skin to appear red after waxing. If discomfort or a burning sensation is experienced, apply a cold compress to the area. If sensation persists, seek medical advice.
- Do NOT store in the bathroom. Store in a dry environment and away from direct sunlight.
- Gel may become ineffective if it comes into contact with water.

PRECAUTIONS FOR WIPES:

- Conduct a test patch on a small patch of skin in the area you wish to treat. If after 24 hours there is no adverse reaction proceed with full application.
- Avoid contact with eyes. If contact occurs rinse with water. If irritation persists seek medical advice.
- For external use only.

TIPS FOR EFFECTIVE HAIR REMOVAL:

- Hair must be at least 3 to 5mm or 1/8 to 1/5 inches long.
- The area must be clean and free from makeup, oil and moisturisers.
- Ensure the area is thoroughly dried after using the cleansing wipes.
- A thin layer of gel should be applied.
- It is important to apply the gel in the direction of the hair growth.
- The skin should be held taut when removing the strip.
- Pull the strip in the opposite direction of hair growth.
- Pull the strip off quickly and parallel to the skin.

For an instructional video & further information visit nads.com